

RIFCO

EST. 1975



Australian Made
Bathroom furniture



From our family, to yours.

Rifco has been making bathroom furniture for over 50 years and is still proudly family owned & operated.

Rifco was founded in 1975 by husband and wife team, Alan and Janet Fletcher, who realised there was a market for quality Australian made bathroom furniture. What began in a small factory in Marrickville NSW making mirrors and shaving cabinets for Sydney stores, has today grown into an operation which now supplies to bathroom retailers nationwide!

Alan and Janet ran the company as 'hands on' owners for 26 years. Throughout that time Rifco developed a reputation for quality products, for friendly service and for family values.

After Alan's sudden passing in 2001, the reins were handed over to their children, Luke, Samuel and Kate who all had active roles in the company.

And so began their dream to extend their parents' legacy and see the Rifco brand become synonymous with quality Australian made products.

This dream continues today. Dedicated to using locally sourced materials, committed to sustainable manufacturing processes and a flair for design innovations that influence market trends, Rifco vanities, shaving cabinets and mirrors have never invoked more pride. Rifco is excited to present to you, a collection especially selected for Tradelink.





Lennox 1200 Wall Hung - Grey Pail Satin with Stadium Acrylic Top

Lennox vanity

FEATURES

- Stylish batten fronts
- Door & drawer combo
- Full extension soft close drawers & door
- Slimline pull or finger pull recess to open
- Wall hung or kick
- Vanity finish in satin or gloss
- Rifco select Dulux colours

TOP OPTIONS

- 12mm Delta China
- 22mm Acrylic top
- 20mm Caesarstone
- 32-40mm Solid timber

SIZES

- Depth: 460
- Height: Wall hung 690
- Kick 840
- Width: 600, 750, 900, 1200, 1500, 1800



Lennox 1200 Kick - Malay Grey Satin with Blackbutt Top



Harper 900 Wall Hung - Natural Walnut with Pure White Caesarstone Top

Harper vanity

FEATURES

- Single drawer
- Full extension soft close drawer
- Slimline pull or finger pull recess to open
- Rifco select Laminex colours

TOP OPTIONS

- 12mm Delta China
- 22mm Acrylic top
- 20mm Caesarstone

SIZE

- Depth: 460
- Height: 400
- Width: 600, 750, 900, 1200, 1500, 1800



RIFCO

EST. 1975



Infinity vanity



Infinity 1200 Kick - White Satin with Blackwood Top



Infinity 900 Double Drawer - White Satin with Blackwood Top

FEATURES

All drawer unit

Full extension soft close drawers

White polyurethane

Solid timber top & feature panel



Infinity 1500 Single Drawer - White Satin with Tas Oak Top

SIZES

Depth: 460

Heights: Single drawer 330

Double drawer 635

Double drawer kick 840

Widths: 600, 750, 900, 1200,
1500, 1800

RIFCO

EST. 1975





Infinity 900 Cabinet - White Satin with Blackwood feature

Infinity mirror cabinet

FEATURES

- Full polished edge mirrored front
- Copper free & UV stable mirror
- Soft close hinges
- 3 Fully adjustable toughened glass shelves
- Solid timber feature panel
- White polyurethane sides

SIZES

Depth: 130

Height: 750

Width: SD 450, DD 600, 750, 900, 3D 1200, 1500

Blush mirror cabinet

FEATURES

- Full polished edge mirrored front
- Copper free & UV stable mirror
- Soft close hinges
- 2 Fully adjustable toughened glass shelves
- White matt sides
- Additional cost for gloss/coloured sides

SIZES

Depth: 130

Height: 800

Width: 400



Blush Mirror Cabinet with white matt sides

Lennox vanity specs

wall hung:

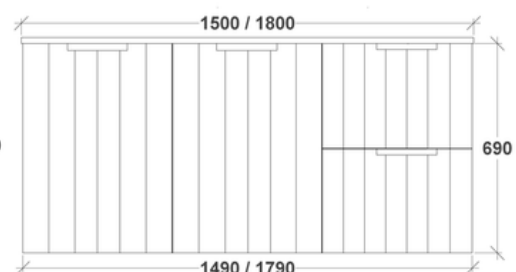
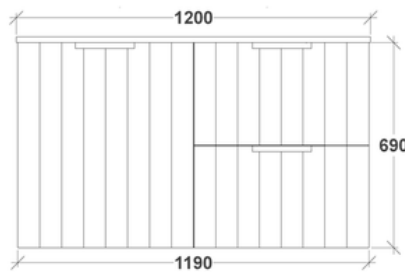
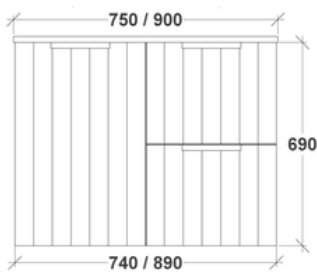
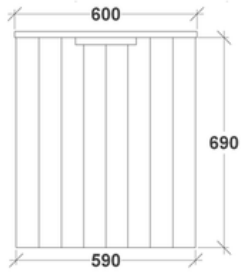

kick:

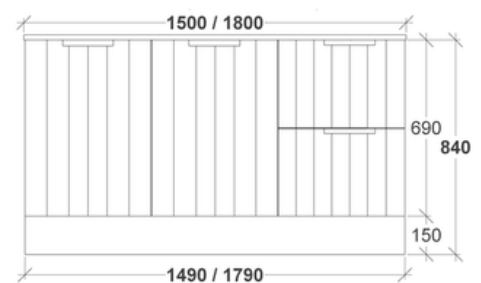
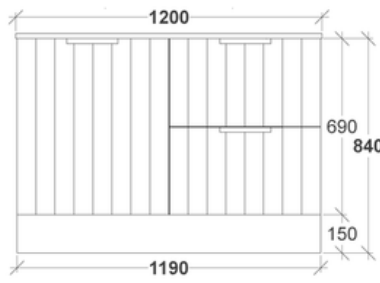
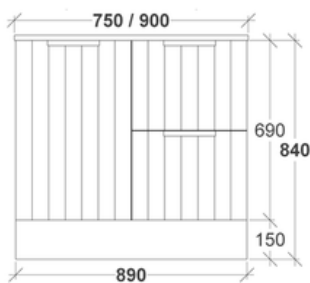
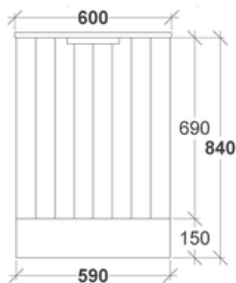
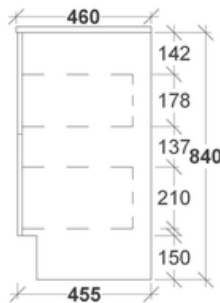

ALL SIZES SHOWN ARE NOMINAL & SHOULD BE CHECKED PRIOR TO INSTALLATION

Infinity vanity specs

single drawer wall hung:



double drawer wall hung:

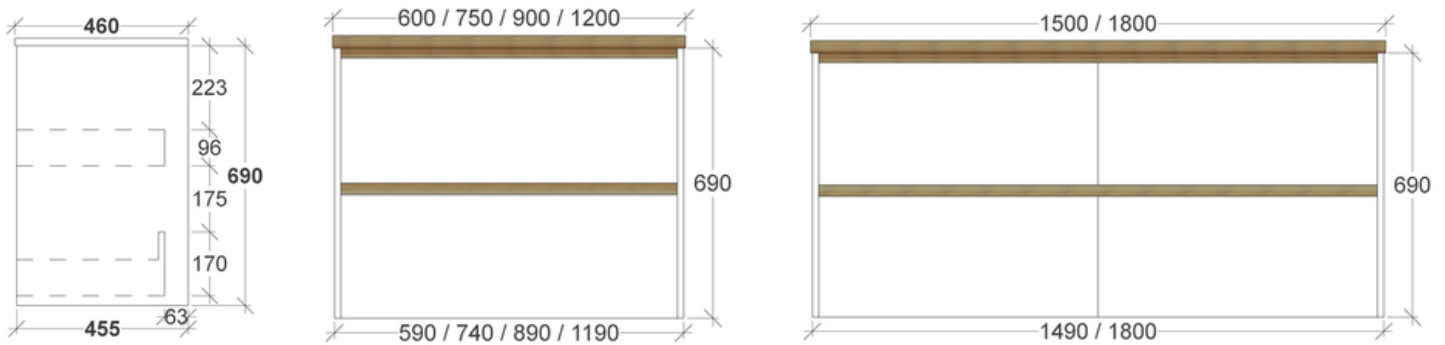

double drawer kick:

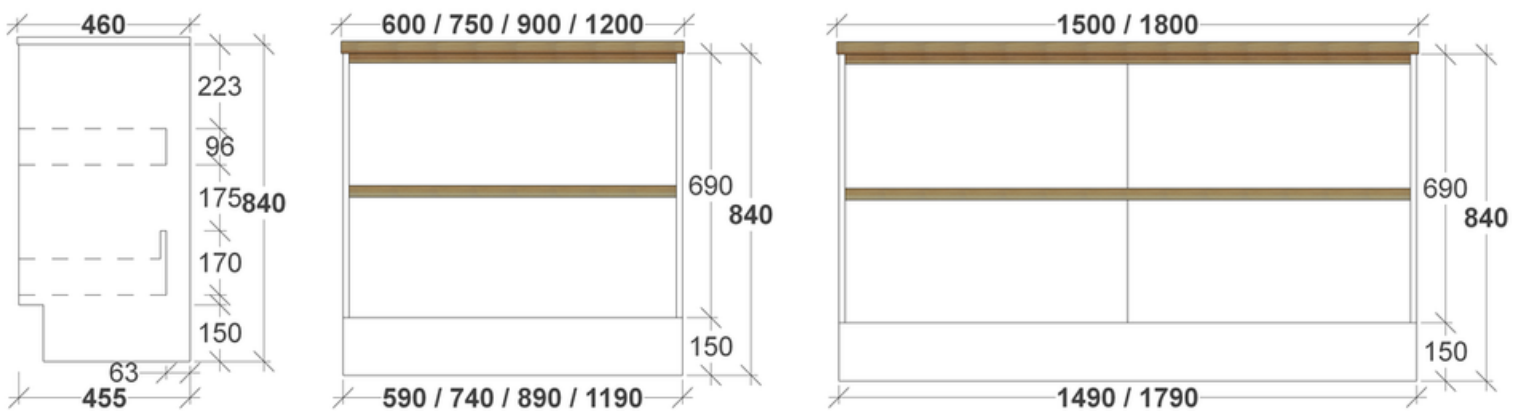

ALL SIZES SHOWN ARE NOMINAL & SHOULD BE CHECKED PRIOR TO INSTALLATION

RIFCO

EST. 1975



Harper

vanity specs

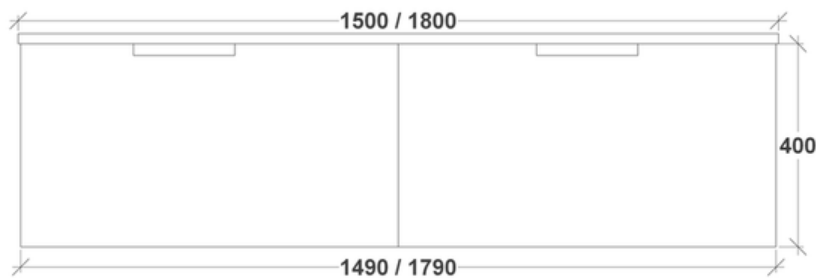
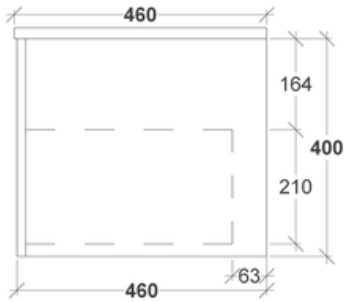

Infinity

mirror cabinet
specs

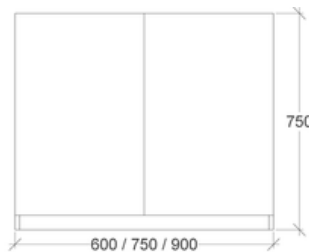
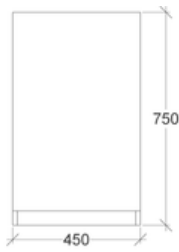
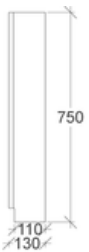

Blush

mirror cabinet
specs

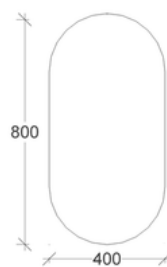

ALL SIZES SHOWN ARE NOMINAL & SHOULD BE CHECKED PRIOR TO INSTALLATION

Colours

LENNOX

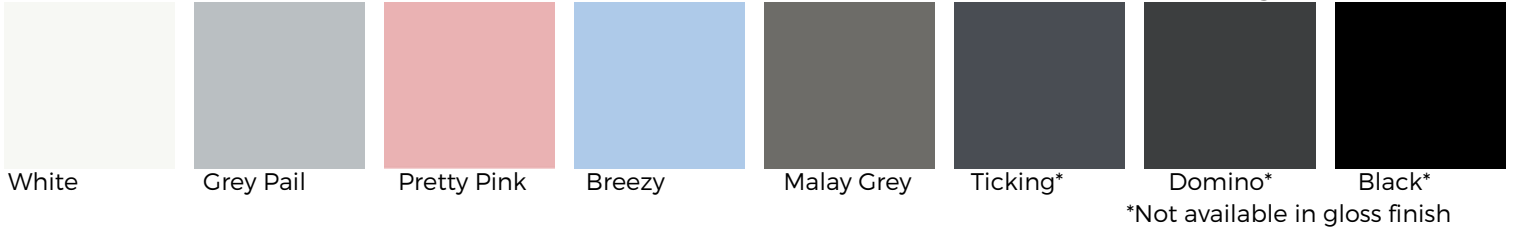

HARPER



Vanity top finishes

INFINITY // LENNOX

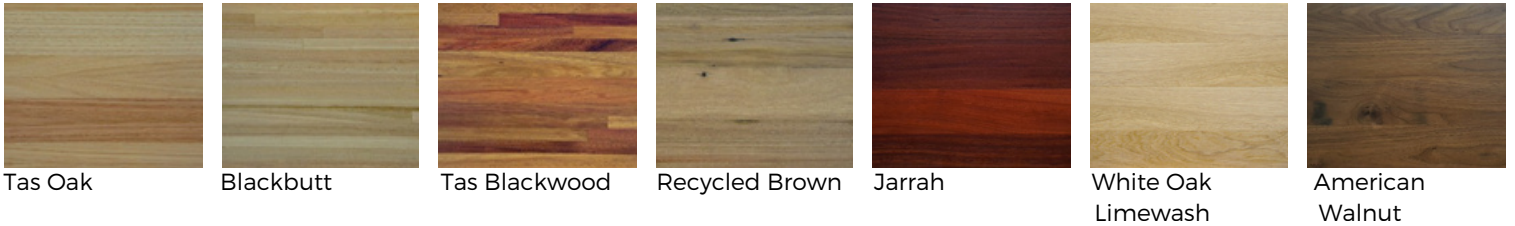

LENNOX // HARPER

caesarstone[®] **ICON** 20mm

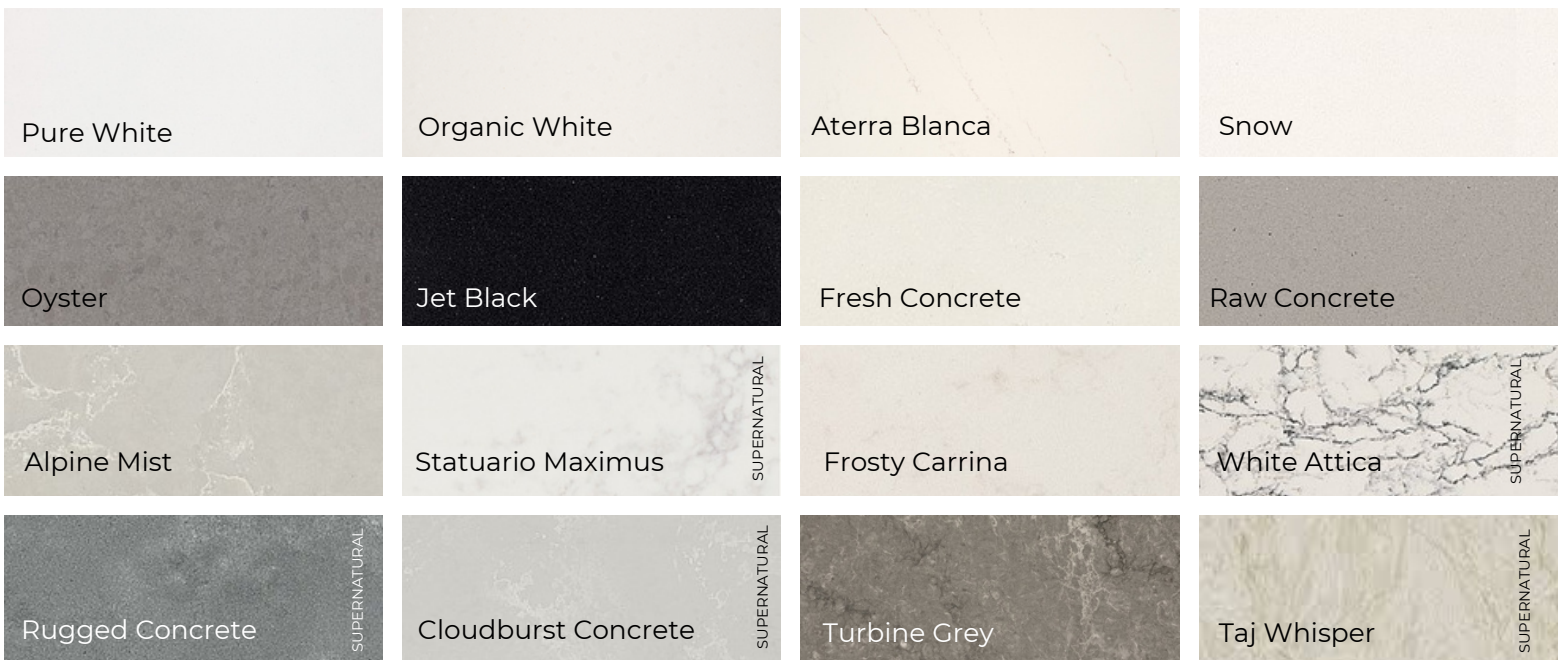

PLEASE NOTE COLOURS MAY VARY FROM WHAT ACTUAL COLOUR SAMPLE IS LIKE

Integrated top options

LENNOX // HARPER



ICON acrylic top
(pictured left)
left or right hand bowl
0, 1, 3 tapholes
22mm thick
sizes 600, 750, 900, 1200

STADIUM acrylic top

(pictured right)
centre bowl
0, 1, 3 tapholes
22mm thick

sizes 600, 750, 900, 1200, 1500, 1800
(1500 and 1800 available with single or double bowl)



DELTA china top

(pictured left)
centred bowl
1 taphole
12mm thick

sizes 600, 750, 900, 1200, 1500
(1500 available with single or double bowl)

Handle options:



Ledge available in white matt, black matt & chrome finishes

RIFCO

EST. 1975



Rifco product quality guarantee

All of our bathroom furniture are made in Australia & made to the highest standards.

We offer a lifetime warranty on all of our hardware as well as the following warranty periods:

All vanities	7years
All Caesarstone® tops	10years
All acrylic tops	10years
All solid timber tops	7years
All china tops & basins	1year
All mirrors & mirrored cabinets	1year
All hardware	Lifetime
Commerical use:	All products 1year

Rifco guarantee against faulty materials and workmanship, provided that the installation is carried out according to the installation instructions and by a licensed installer. (see our website for installation instructions)

Please note that no claims for damages / defects will be recognised after installation.

Should you find any fault with either materials or workmanship within its warranty period, Rifco will at its own cost, repair or, at its option, supply a replacement for the faulty product or component. Contact your retailer.

The liability of the warranty and guarantee is limited to a replacement cabinet or part thereof of similar value and does not include any service costs or related damage. This guarantee does not cover damage by improper installation, accident, misuse, abuse, neglect, negligence, excessive wear and tear, improper care and maintenance, water and natural causes such as sunlight, humidity and other environmental conditions.

All of our cabinets are manufactured from Australian Made HMR board (highly moisture resistant) but are not waterproof. Care must be taken to immediately dry any spillage or leakage of water that may gain access to the cabinet as water damage is not a justifiable claim. Installation, cleaning and maintenance instructions need to be followed.

Our goods come with guarantees that cannot be excluded under the Australian Consumer Law. You are entitled to a replacement or refund for a major failure and for compensation for any other reasonably foreseeable loss or damage. You are also entitled to have the goods repaired or replaced if the goods fail to be of acceptable quality and the failure does not amount to a major failure.

RIFCO

EST. 1975





Rifco Trading Pty Ltd

ABN 49 101 595 466 ACN 101 595 466
PO Box 2142 Smithfield NSW 2164

PHONE 02 9737 8226
EMAIL rifco@rifco.com.au

www.rifco.com.au

